



EPT20-15EHJ

Semi Electric Truck 1.5t

■ New Choice of Entry-level Electric Pallet Truck

EP EQUIPMENT CO.,LTD
www.ep-ep.com



▣ FEATURE

■ Light Weight, Great Capacity, Excellent Passingability:

1500KG capacity, light weight and compact size equivalent to hand pallet trucks.

■ Patented Design:

New Integrated Control Head Design, Easy & Comfortable Operation.

■ External Control System:

Patent designed external control system not only protects controller in place but also provides easy access for maintenance.

■ Operation:

Ergonomically-designed tiller head helps increase efficiency; Internal Charger for Easy Charging.

■ Safety:

Handy Emergency Disconnect Button & Durable Driving Unit ensure safety under any situation.

■ Maintenance:

Assembly Components, Easy for Diagnosis and Replacing.



Semi Electric Truck 1.5t

EPT20-15EHJ

Distinguishing mark			
1.1	Manufacturer		EP
1.2	Model designation		EPT20-15EHJ
1.3	Drive unit		Electric
1.4	Type of operation		pedestrian
1.5	Rated capacity	Q kg	1500
1.6	Load center distance	c mm	600
1.8	Load distance	x mm	883/946
1.9	Wheelbase	y mm	1152/1215
Weight			
2.1	Service weight (include battery)	kg	140
2.2	Axle loading, laden driving side/loading side	kg	540/1100
2.3	Axle loading, unladen driving side/loading side	kg	110/30
Types,Chassis			
3.1	Tyre type driving wheels/loading wheels		PU/PU
3.2	Tyre size, driving wheels (diameter*width)	mm	Φ210x70
3.3	Tyre size, loading wheels (diameter*width)	mm	2x Φ80x60 (Φ74x88)
3.4	Tyre size, caster wheels (diameter*width)	mm	
3.5	Wheels, number driving, caster/loading (x=drive wheels)	mm	1x /4
3.6	Track width, front,driving side	b ₁₀ mm	
3.7	Track width,rear,loading side	b ₁₁ mm	410 (535)
Dimensions			
4.4	Lift height	h ₃ mm	115
4.9	Height drawbar in driving position min./max.	h ₁₄ mm	715/1280
4.15	Lowered height	h ₁₃ mm	85(75)
4.19	Overall length	l ₁ mm	1588
4.2	Length to face of forks	l ₂ mm	438
4.21	Overall width	b ₁ / b ₂ mm	560(685)
4.22	Fork dimensions	s/ e/ l mm	50/150/1150
4.25	Distance between fork-arms	b ₅ mm	560/685
4.32	Ground clearance, center of wheelbase	m ₂ mm	35
4.34.1	Aisle width for pallets 1000 × 1200 crossways	Ast mm	1669
4.34.2	Aisle width for pallets 800 × 1200 lengthways	Ast mm	1869
4.35	Turning radius	Wa mm	1415
Performance data			
5.1	Travel speed, laden/ unladen	km/ h km/h	3.5/4
5.2	Lifting speed, laden/ unladen	m/ s	10mm/time
5.3	Lowering speed, laden/ unladen	m/ s	Controlable
5.8	Max. gradeability, laden/unladen		2/6
5.1	Service brake type		Electromagnetic
Electric-engine			
6.1	Drive motor rating S2 60 min	kW	0.65
6.2	Lift motor rating at S3 15%	kW	Manual Lifting
6.3	The maximum allowed size battery	mm	185/125/190
6.4	Battery voltage/nominal capacity K20		24/30
6.5	Battery weight	kg	9.5*2
Addition data			
8.1	Type of drive control		DC
10.5	Steering type		Mechanical
10.7	Sound pressure level at the driver's ear		74

1.The parameters in the table are of the standard model. For more information, please contact us.

2.The parameters are subject to change without notice.

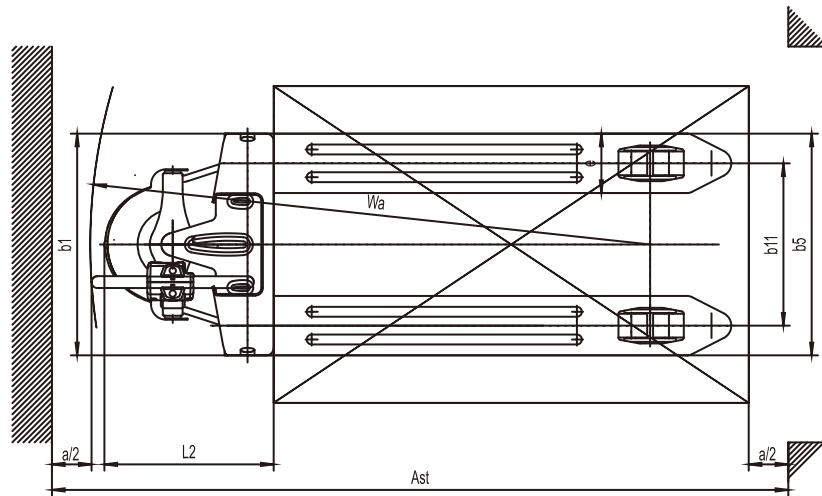
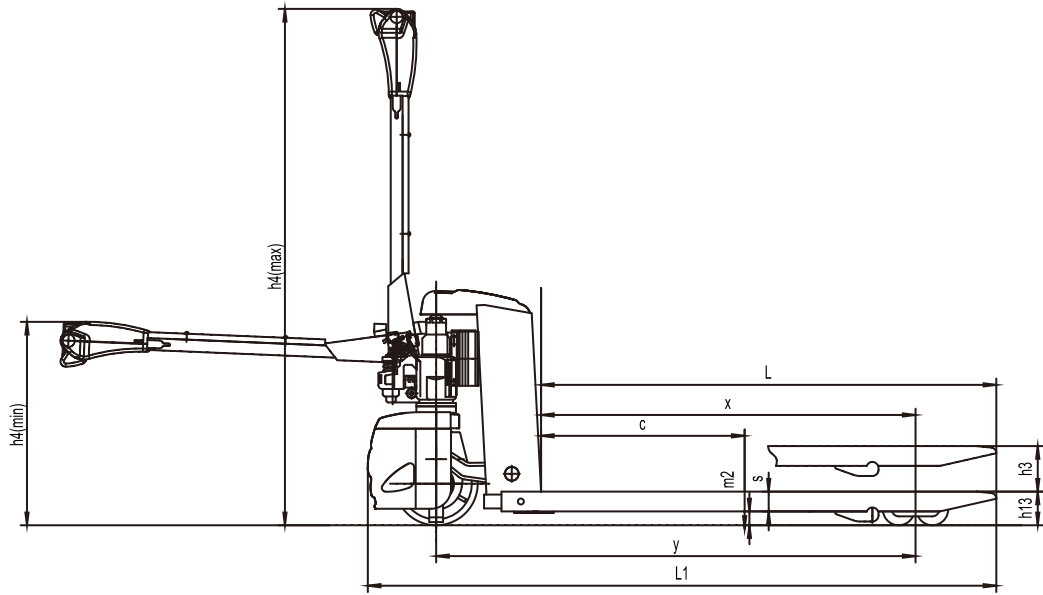

Option

Options	EPT20-15EHJ
Fork length	●800/915/1000/1070/1100/1300/1400mm
Fork width	●520/600mm
Single load wheel	●
Driving wheel	PU wheel with Pattern
Scale	●